



CHARITY  
REALTY  
INTERNATIONAL



**360 NORTH FRONTAGE ROAD**

## BUILDING INFORMATION

### LOCATION

360 N Frontage Rd  
Roxbury, NJ 07850

### BUILDING SIZE

18,670 SF

### OFFICE

6,300 SF

### CEILING HEIGHT

12' Clear

### COLUMNS

17' x 22.5'

### PARKING

51 Surface Spaces

### FLOORS

Concrete Slab with Epoxy

### LOADING DOORS

2 Tailboard - 8' x 10'  
100' Loading Platform

### POWER

3 Phase / 1000 Amps

### BACK-UP GENERATOR

250 KW Natural Gas

### HEAT

Roof Top Package Units

### AIR CONDITIONING

Office & Warehouse

### WATER & PLUMBING

Well & Septic

### ZONING

Limited Industrial

### BLOCK

9501

### LOT

8

### LEASE PRICE

\$10.25/SF Net

### LOT SIZE

4.16 AC

### TAXES & CAM

\$3.50/SF

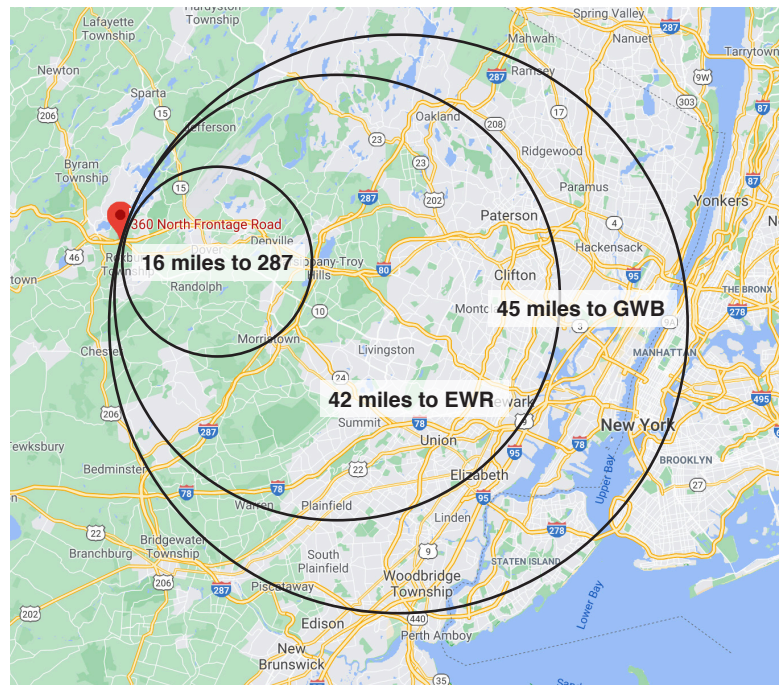

**James F. Costanzo**  
President | Broker of Record

**(973) 714 – 1110**

Knowledge | Hardwork | Results | Philanthropy

Information contained herein is deemed from sources we consider reliable. We cannot be responsible for errors, omissions, prior sales, withdrawal or change of price. Landlord and broker make no representation as to the environmental condition of the property and recommend independent investigations.

# 360 N. FRONTAGE PLAN

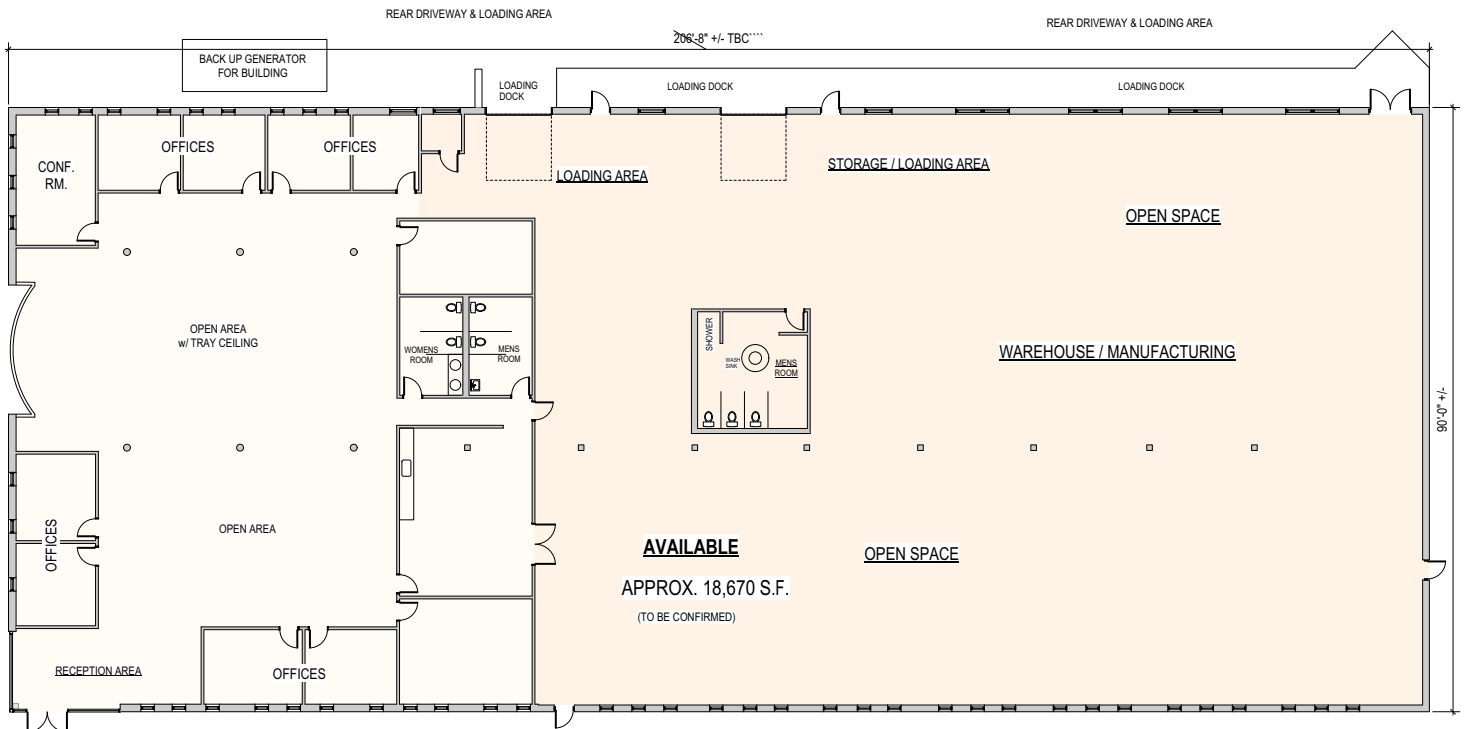

EXISTING CONDITIONS TO BE CONFIRMED  
ALL DIMENSIONS ARE APPROXIMATE - V.I.F.

**PROPOSED CONCEPT SCHEMATIC**  
**FLOOR PLAN**

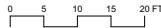

360 N. Frontage Road  
Roxbury, NJ

**James F. Costanzo**  
President | Broker of Record

**(973) 714 – 1110**  
Knowledge | Hardwork | Results | Philanthropy

Information contained herein is deemed from sources we consider reliable. We cannot be responsible for errors, omissions, prior sales, withdrawal or change of price. Landlord and broker make no representation as to the environmental condition of the property and recommend independent investigations.